

REVISIONS		DATE
REV	DESCRIPTION	
A	INITIAL RELEASE	11-3-2014

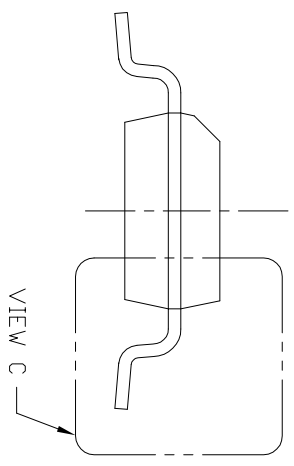
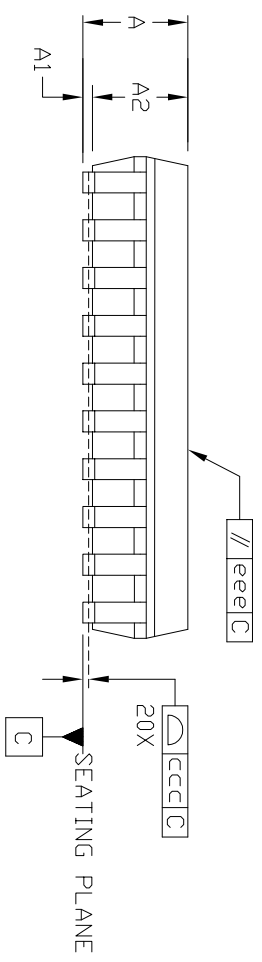
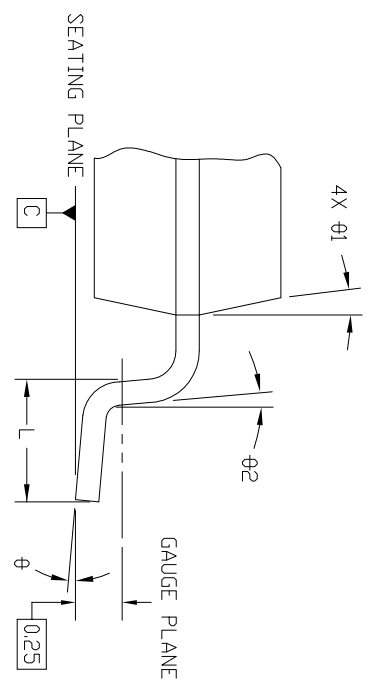
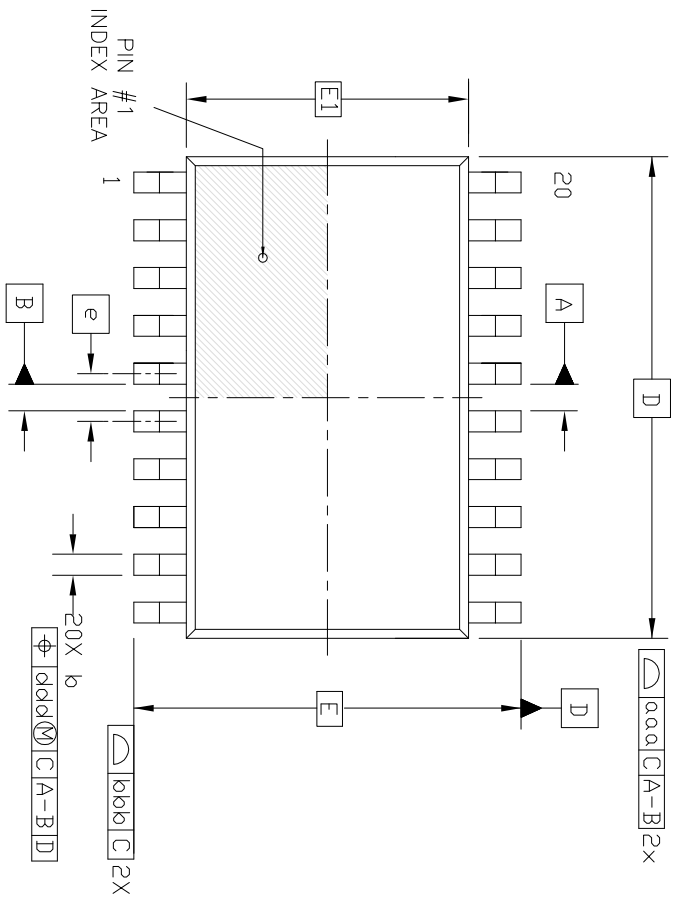

- NOTES:
- 1) ALL DIMENSIONS IN MM, ANGLES IN DEGREES
  - 2) DIMENSIONING AND TOLERANCING PER ASME Y14.5-2009
  - 3) CONFORMS TO JEDEC OUTLINE MS-013

SYMBOL	MIN	MAX	SYMBOL	MIN	MAX
A	-	2.72	aaa	0.10	
A1	0.15	0.30	bbb	0.30	
A2	2.38	2.46	ccc	0.10	
b	0.15	0.25	ddd	0.25	
D	12.80	BSC	eee	0.10	
E	10.30	BSC	φ	0	8
E1	7.50	BSC	φ1	5	15
e	1.27	BSC	φ2	0	-
L	0.40	1.27			

**PROMEX INDUSTRIES INC.**  
[www.promex-ind.com](http://www.promex-ind.com)

TITLE  
 SOIC 20L 0.300" BODY 1.27 PITCH  
 PACKAGE OUTLINE

DWG NO.  
 20L-SOIC-300W-127P.DWG

DO NOT SCALE

FILE NAME  
 20L-SOIC-300W-127P.DWG

SHEET  
 1 OF 1

REV  
 A

ALL INFORMATION CONTAINED HEREIN IS THE PROPERTY OF PROMEX, INC. AND IS CONSIDERED PROPRIETARY AND SUBJECT TO RETURN UPON DEMAND. ACCEPTANCE AND RETENTION HEREOF CONSTITUTES AGREEMENT BY THE RECIPIENT THAT THE INFORMATION WILL NOT BE DISCLOSED TO ANY OTHER PARTY WITHOUT THE WRITTEN PERMISSION OF PROMEX, INC.