

REVISIONS		DATE
REV	DESCRIPTION	
A	INITIAL RELEASE	11-3-2014

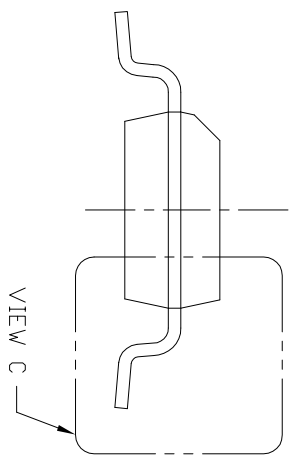
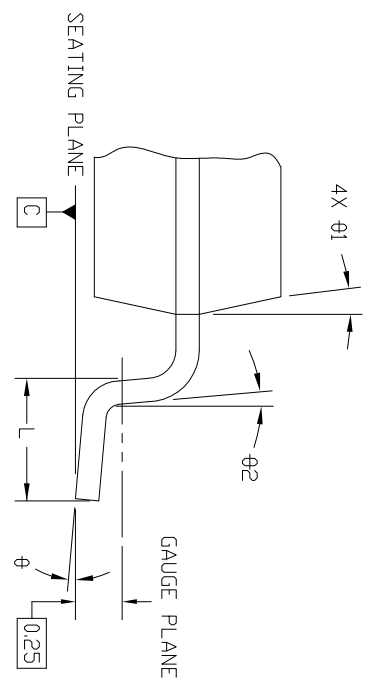
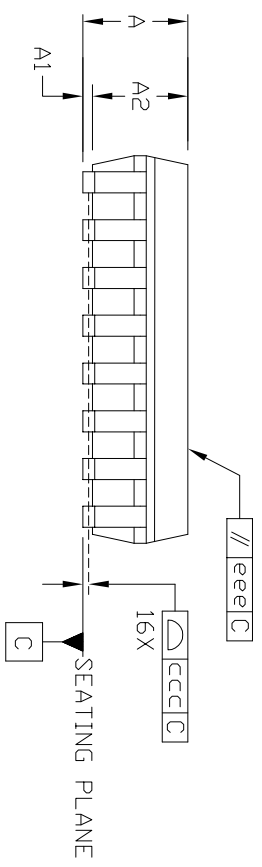
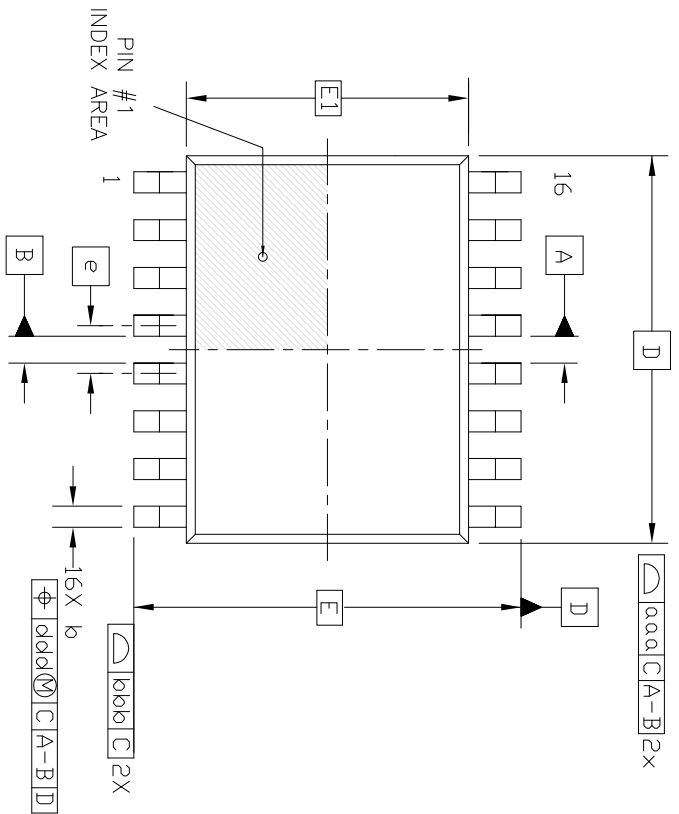

- NOTES:
- 1) ALL DIMENSIONS IN MM, ANGLES IN DEGREES
 - 2) DIMENSIONING AND TOLERANCING PER ASME Y14.5-2009
 - 3) CONFORMS TO JEDEC OUTLINE MS-013

ALL INFORMATION CONTAINED HEREIN IS THE PROPERTY OF PROMEX, INC. AND IS CONSIDERED PROPRIETARY AND SUBJECT TO RETURN UPON DEMAND. ACCEPTANCE AND RETENTION HEREOF CONSTITUTES AGREEMENT BY THE RECIPIENT THAT THE INFORMATION WILL NOT BE DISCLOSED TO OTHERS WITHOUT THE WRITTEN PERMISSION OF PROMEX, INC. WITHOUT FURTHER WRITTEN PERMISSION.

SYMBOL	MIN	MAX	SYMBOL	MIN	MAX
A	-	2.72	aaa	0.10	
A1	0.15	0.30	bbb	0.30	
A2	2.38	2.46	ccc	0.10	
b	0.15	0.25	ddd	0.25	
D	10.30	BSC	eee	0.10	
E	10.30	BSC	ϕ	0	8
E1	7.50	BSC	ϕ 1	5	15
e	1.27	BSC	ϕ 2	0	-
L	0.40	1.27			

<p>PROMEX INDUSTRIES INC. www.promex-ind.com</p>	
<p>TITLE SOIC 16L 0.300" BODY 1.27 PITCH PACKAGE OUTLINE</p>	
DWG NO.	16L-SOIC-300W-127P.DWG
DO NOT SCALE	FILE NAME
16L-SOIC-300W-127P.DWG	SHEET
1	OF 1
REV	A